

Timing Pulley

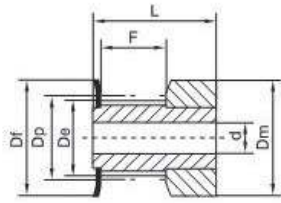

Type 0F

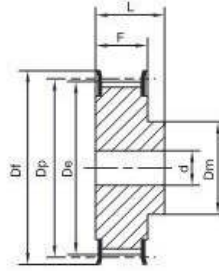

Type 1F

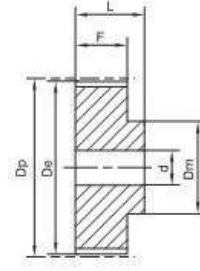

Type 8

HTB3M-15

INFO	Size	Z	Type	Dp	De	Df	Dm	F	L	d	Flange No.	
ALUMINIUM	WITH FLANGE	10-3M-15	10	0F	9.55	8.79	13.0	13.0	17.0	26.0	-	501
		12-3M-15	12	0F	11.46	10.70	15.0	15.0	17.0	26.0	-	502
		14-3M-15	14	0F	13.37	12.61	16.0	16.0	17.0	26.0	-	503
		15-3M-15	15	0F	14.32	13.56	17.5	17.5	17.0	26.0	-	516
		16-3M-15	16	1F	15.28	14.52	17.5	10.0	19.5	26.0	4.0	504
		18-3M-15	18	1F	17.19	16.43	20.0	11.0	19.5	26.0	6.0	505
		20-3M-15	20	1F	19.10	18.34	23.0	13.0	19.5	26.0	6.0	517
		21-3M-15	21	1F	20.05	19.29	25.0	14.0	19.5	26.0	6.0	518
		22-3M-15	22	1F	21.01	20.25	25.0	14.0	19.5	26.0	6.0	518
		24-3M-15	24	1F	22.92	22.16	25.0	14.0	19.5	26.0	6.0	518
	26-3M-15	26	1F	24.83	24.07	28.0	16.0	19.5	26.0	6.0	508	
	28-3M-15	28	1F	26.74	25.98	32.0	18.0	19.5	26.0	6.0	509	
	30-3M-15	30	1F	28.65	27.89	32.0	20.0	19.5	26.0	6.0	509	
	32-3M-15	32	1F	30.56	29.80	36.0	22.0	19.5	26.0	6.0	510	
	36-3M-15	36	1F	34.38	33.62	39.0	26.0	20.0	30.0	6.0	519	
	40-3M-15	40	1F	38.20	37.44	42.0	28.0	20.0	30.0	6.0	513	
	44-3M-15	44	1F	42.02	41.26	48.0	33.0	20.0	30.0	6.0	520	
	WITHOUT FLANGE	48-3M-15	48	8	45.84	45.08	-	33.0	20.0	30.0	8.0	-
		60-3M-15	60	8	57.30	56.54	-	33.0	20.0	30.0	8.0	-
		72-3M-15	72	8	68.75	67.99	-	33.0	20.0	30.0	8.0	-

B.V. TRANSMISSION INDUSTRIES

18, Khyati Industrial Estate, Laxmi Nagar, Near Bangur Nagar, Link Road, Goregaon (West), Mumbai - 400 090, INDIA
 Tel. : +91-22-2876 2345 / 2878 7363 Fax : +91-22-28767941 e-mail : bvchain@rediffmail.com / bvchain@gmail.com

Mobile : +91-93247 18035 / 98206 92004

Website : www.bvchain.com

Timing Pulley

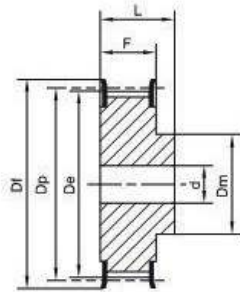

Type 1F

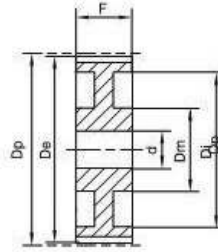

Type 7

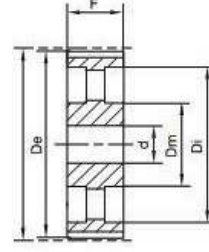

Type 5

HTB 14M-170

INFO		Size	Z	Type	Dp	De	Df	Dm	Di	F	L	d	Flange No.		
STEEL	WITH FLANGE	28-14M-170	28	1F	124.78	122.12	128	100	-	187	202	-	153		
		*29-14M-170	29	1F	129.23	126.57	138	100	-	187	202	-	154		
		30-14M-170	30	1F	133.69	130.99	138	100	-	187	202	-	154		
		32-14M-170	32	1F	142.60	139.88	154	100	-	187	202	-	160		
		34-14M-170	34	1F	151.52	148.79	160	100	-	187	202	-	166		
		36-14M-170	36	1F	160.43	157.68	168	120	-	187	202	-	168		
		38-14M-170	38	1F	169.34	166.60	183	135	-	187	202	-	172		
		40-14M-170	40	1F	178.25	175.49	188	140	-	187	202	-	162		
		*44-14M-170	44	1F	196.08	193.28	211	160	-	187	202	-	175		
		*48-14M-170	48	1F	213.90	211.11	226	160	-	187	202	-	180		
		*56-14M-170	56	1F	249.55	246.76	256	160	-	187	202	-	182		
		*64-14M-170	64	1F	285.21	282.41	296	180	-	187	202	-	184		
		CAST-IRON	WITHOUT FLANGE	*72-14M-170	72	7	320.86	318.06	-	180	278	187	187	32	-
				80-14M-170	80	7	356.51	353.71	-	180	314	187	187	32	-
90-14M-170	90			5	401.07	398.28	-	180	358	187	187	38	-		
112-14M-170	112			5	499.11	496.32	-	200	456	187	187	38	-		
144-14M-170	144			5	641.71	638.92	-	220	600	187	187	38	-		
168-14M-170	168			5	748.66	745.87	-	220	706	187	187	38	-		
*192-14M-170	192			5	855.61	852.82	-	220	813	187	187	38	-		
*216-14M-170	216			5	962.57	959.76	-	220	920	187	187	38	-		

B.V. TRANSMISSION INDUSTRIES

18, Khyati Industrial Estate, Laxmi Nagar, Near Bangur Nagar, Link Road, Goregaon (West), Mumbai - 400 090, INDIA
 Tel. : +91-22-2876 2345 / 2878 7363 Fax : +91-22-28767941 e-mail : bvchain@rediffmail.com / bvchain@gmail.com

Mobile : +91-93247 18035 / 98206 92004

Website : www.bvchain.com

Timing Pulley

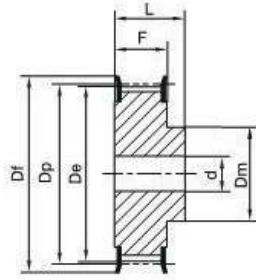

Type 1F

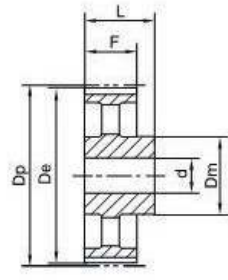

Type 4

XH400 PITCH 7/8" 22.22mm

INFO		Size	Type	Z	Dp	De	Df	Dm	F	L	d	Flange No.
STEEL	WITH FLANGE	18 XH 400	1F	18	127.34	124.55	140.0	100	118	132	32	155
		19 XH 400	1F	19	134.41	131.62	146.0	100	118	132	32	156
		20 XH 400	1F	20	141.49	138.69	155.0	100	118	132	32	157
		21 XH 400	1F	21	148.56	145.77	160.0	110	118	132	32	158
		22 XH 400	1F	22	155.64	152.84	170.0	110	118	132	32	159
		24 XH 400	1F	24	169.79	166.99	184.0	120	118	132	32	161
		25 XH 400	1F	25	176.86	174.07	188.0	120	118	132	32	162
		26 XH 400	1F	26	183.93	181.14	198.0	120	118	132	32	163
		27 XH 400	1F	27	191.01	188.22	205.0	120	118	132	32	164
		28 XH 400	1F	28	198.09	195.29	212.0	150	118	132	32	165
		30 XH 400	1F	30	212.23	209.44	227.0	150	118	132	32	167
		32 XH 400	1F	32	226.38	223.59	240.0	150	118	132	32	169
		34 XH 400	1F	34	240.53	237.74	256.0	150	118	132	32	170
		CAST-IRON	WITHOUT FLANGE	*38 XH 400	4	38	268.83	266.03	-	150	118	132
*40 XH 400	4			40	282.98	280.18	-	150	118	132	32	-
*48 XH 400	4			48	339.57	336.78	-	175	118	132	32	-
*60 XH 400	4			60	424.47	421.67	-	175	118	132	32	-
*72 XH 400	4			72	509.36	506.56	-	175	118	132	32	-
*84 XH 400	4			84	594.25	591.46	-	175	118	132	32	-
*96 XH 400	4			96	679.15	676.35	-	175	118	132	32	-
*120 XH 400	4			120	848.93	846.14	-	175	118	132	32	-

B.V. TRANSMISSION INDUSTRIES

18, Khyati Industrial Estate, Laxmi Nagar, Near Bangur Nagar, Link Road, Goregaon (West), Mumbai - 400 090, INDIA
 Tel. : +91-22-2876 2345 / 2878 7363 Fax : +91-22-28767941 e-mail : bvchain@rediffmail.com / bvchain@gmail.com
 Mobile : +91-93247 18035 / 98206 92004

Website : www.bvchain.com

Timing Pulley

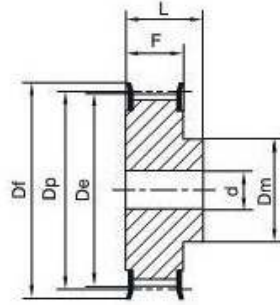

Type 1F

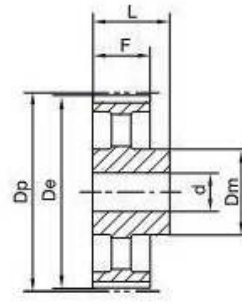

Type 4

H300 PITCH 1/2" (12.70mm)

INFO		Size	Type	Z	Dp	De	Df	Dm	F	L	d	Flange No.
STEEL	WITH FLANGE	14 H 300	1F	14	56.59	55.22	64.0	42	85.7	100	-	59
		15 H 300	1F	15	60.64	59.27	66.5	45	85.7	100	-	60
		16 H 300	1F	16	64.67	63.31	70.0	45	85.7	100	-	61
		17 H 300	1F	17	68.72	67.35	75.0	45	85.7	100	-	62
		18 H 300	1F	18	72.77	71.39	79.0	55	85.7	100	-	63
		19 H 300	1F	19	76.81	75.44	82.5	60	85.7	100	-	64
		20 H 300	1F	20	80.85	79.48	87.0	62	85.7	100	-	76
		21 H 300	1F	21	84.89	83.52	91.0	65	85.7	100	-	66
		22 H 300	1F	22	88.93	87.56	94.0	68	85.7	100	-	67
		23 H 300	1F	23	92.98	91.61	97.0	72	85.7	100	-	68
		24 H 300	1F	24	97.03	95.65	102.0	72	85.7	100	-	70
		25 H 300	1F	25	101.06	99.69	106.0	72	85.7	100	-	71
		26 H 300	1F	26	105.11	103.73	112.0	80	85.7	100	-	72
		27 H 300	1F	27	109.15	107.78	115.0	80	85.7	100	-	74
		28 H 300	1F	28	113.18	111.82	120.0	80	85.7	100	-	75
		30 H 300	1F	30	121.29	119.90	128.0	80	85.7	100	-	78
		32 H 300	1F	32	129.30	127.99	135.0	80	85.7	100	-	80
		33 H 300	1F	33	133.40	132.03	142.0	80	85.7	100	-	81
		34 H 300	1F	34	137.45	136.07	142.0	80	85.7	100	-	81
		35 H 300	1F	35	141.49	140.12	150.0	80	85.7	100	-	85
		36 H 300	1F	36	145.54	144.16	150.0	80	85.7	100	-	85
		38 H 300	1F	38	153.62	152.24	158.0	80	85.7	100	-	86
40 H 300	1F	40	161.70	160.33	168.0	80	85.7	100	-	90		
42 H 300	1F	42	169.79	168.41	180.0	80	85.7	100	-	94		
CAST-IRON	WITHOUT FLANGE	44 H 300	4	44	177.88	176.50	-	80	85.7	100	24	-
		48 H 300	4	48	194.03	192.67	-	90	85.7	100	24	-
		50 H 300	4	50	202.13	200.75	-	90	85.7	100	24	-
		58 H 300	4	58	234.47	233.09	-	90	85.7	100	24	-
		60 H 300	4	60	242.55	241.18	-	120	85.7	100	24	-
		72 H 300	4	72	291.06	289.69	-	120	85.7	100	28	-
		84 H 300	4	84	339.57	338.20	-	120	85.7	100	28	-
		96 H 300	4	96	388.09	386.71	-	120	85.7	100	28	-
120 H 300	4	120	485.12	483.73	-	120	85.7	100	28	-		

B.V. TRANSMISSION INDUSTRIES

18, Khyati Industrial Estate, Laxmi Nagar, Near Bangur Nagar, Link Road, Goregaon (West), Mumbai - 400 090, INDIA
 Tel. : +91-22-2876 2345 / 2878 7363 Fax : +91-22-28767941 e-mail : bvchain@rediffmail.com / bvchain@gmail.com

Mobile : +91-93247 18035 / 98206 92004

Website : www.bvchain.com

Timing Pulley

Fenner Synchronous belt range comprises Timing, High Torque Drive (HTD) and Torque Drive Plus (TDP) belts covering drives upto 50 kW, 200 kW & 500 kW respectively.

The original trapezoidal cross section of timing belt has undergone considerable development culminating first in the introduction of High Torque Drive belts and then Torque Drive Plus belts with their associated pulleys. The HTD & TDP belts have curvilinear tooth profile which enables the strength of high tensile load bearing cords to be fully utilised. The shape of teeth gives more uniform stress distribution and allows higher overall loading. The belt teeth are precisely formed and accurately spaced to ensure correct engagement with teeth on the pulleys. Tooth root lines lie substantially on pitch line, thus circular pitch is not altered while flexing.

Accurately spaced polychloroprene teeth ensure smooth engagement with the pulley grooves. HTD & TDP Belt Drives do not depend on the thickness to develop high tensile strength. Being thin, heat build up is minimised without sacrificing inherent power transmission capacity. Synchronous Belt Drives work over a range of shaft speeds maintaining a high transmission efficiency and constant angular velocity. Fenner Synchronous Drives extend these advantages to higher powers and torques, making possible designing of more compact drives.

Fenner Synchronous Belt Drives use Fenner Timing Pulleys provided with the unique Taper Lock System used widely the world over for fixing pulleys on shafts.



FEATURES

- Positive non-slip drive maintains exact speed ratio without creep or slip.
- Minimum heat build up results in cooler operations.
- Do not stretch in use and are corrosion free, clean operation makes them ideal for contamination sensitive applications.
- Moderate oil resistant and electrically conductive according to ISO 9563
- Can withstand temperatures between - 20 Deg C to 100 Deg C.

B.V. TRANSMISSION INDUSTRIES

18, Khyati Industrial Estate, Laxmi Nagar, Near Bangur Nagar, Link Road, Goregaon (West), Mumbai - 400 090, INDIA
Tel. : +91-22-2876 2345 / 2878 7363 Fax : +91-22-28767941 e-mail : bvchain@rediffmail.com / bvchain@gmail.com
Mobile : +91-93247 18035 / 98206 92004

Website : www.bvchain.com

Timing Pulley

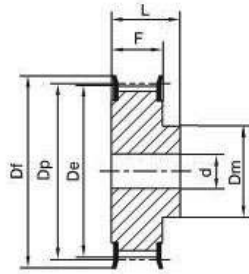

Type 1F

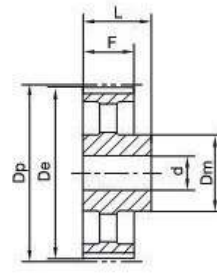

Type 4

L075 PITCH 3/8" (9.525mm)

INFO		Size	Type	Z	Dp	De	Df	Dm	F	L	d	Flange No.
STEEL	WITH FLANGF	10 L 075	1F	10	30.33	29.56	37.0	20	25.4	38	8	50
		11 L 075	1F	11	33.35	32.59	37.0	22	25.4	38	8	50
		12 L 075	1F	12	36.37	35.62	43.0	24	25.4	38	8	52
		13 L 075	1F	13	39.41	38.65	44.0	28	25.4	38	8	83
		14 L 075	1F	14	42.44	41.68	48.0	28	25.4	38	11	54
		15 L 075	1F	15	45.48	44.72	51.0	34	25.4	38	11	55
		16 L 075	1F	16	48.51	47.75	54.0	36	25.4	38	11	56
		17 L 075	1F	17	51.54	50.78	57.0	36	25.4	38	11	57
		18 L 075	1F	18	54.59	53.81	60.0	40	25.4	38	11	58
		19 L 075	1F	19	57.61	56.84	64.0	40	25.4	38	11	59
		20 L 075	1F	20	60.63	59.88	66.5	40	25.4	38	11	60
		21 L 075	1F	21	63.68	62.91	70.0	45	25.4	38	11	61
		22 L 075	1F	22	66.70	65.94	75.0	45	25.4	38	11	62
		23 L 075	1F	23	69.73	68.97	79.0	55	25.4	38	11	63
		24 L 075	1F	24	72.77	72.00	79.0	55	25.4	38	11	63
		25 L 075	1F	25	75.80	75.04	82.5	58	25.4	38	11	64
		26 L 075	1F	26	78.84	78.07	86.0	58	25.4	38	11	65
		27 L 075	1F	27	81.86	81.10	86.0	58	25.4	38	11	65
		28 L 075	1F	28	84.89	84.13	91.0	58	25.4	38	11	66
		30 L 075	1F	30	90.96	90.20	97.0	70	25.4	38	11	68
		32 L 075	1F	32	97.03	96.26	102.0	70	25.4	38	11	70
		33 L 075	1F	33	100.05	99.29	106.0	70	25.4	38	11	71
		34 L 075	1F	34	103.08	102.32	112.0	70	25.4	38	11	72
		35 L 075	1F	35	106.12	105.35	112.0	70	25.4	38	11	72
36 L 075	1F	36	109.14	108.39	115.0	70	25.4	38	11	74		
40 L 075	1F	40	121.29	120.51	128.0	70	25.4	38	11	78		
42 L 075	1F	42	127.34	126.57	135.0	70	25.4	38	11	80		
44 L 075	1F	44	133.40	132.64	142.0	70	25.4	38	11	81		
45 L 075	1F	45	136.44	135.67	142.0	70	25.4	38	11	81		
48 L 075	1F	48	145.54	144.77	150.0	70	25.4	38	11	85		
CAST-IRON	WITHOUT FLANGF	50 L 075	4	50	151.60	150.83	-	70	25.4	38	14	-
		52 L 075	4	52	157.66	156.90	-	70	25.4	38	14	-
		56 L 075	4	56	169.79	169.02	-	70	25.4	38	14	-
		57 L 075	4	57	172.82	172.06	-	70	25.4	38	14	-
		60 L 075	4	60	181.92	181.15	-	75	25.4	45	14	-
		72 L 075	4	72	218.29	217.53	-	75	25.4	45	14	-
		84 L 075	4	84	254.69	253.92	-	75	25.4	45	14	-
		96 L 075	4	96	291.06	290.30	-	75	25.4	45	14	-

B.V. TRANSMISSION INDUSTRIES

18, Khyati Industrial Estate, Laxmi Nagar, Near Bangur Nagar, Link Road, Goregaon (West), Mumbai - 400 090, INDIA
 Tel. : +91-22-2876 2345 / 2878 7363 Fax : +91-22-28767941 e-mail : bvchain@rediffmail.com / bvchain@gmail.com
 Mobile : +91-93247 18035 / 98206 92004

Website : www.bvchain.com